

SUPERIOR 3D LINE

STANDARD EQUIPMENT

Both - sided sash overlapping panel 95.5mm. Aluminium thickness 3mm and 2x2mm. Inox ornaments on the same level with alu sheets.

- > **3 hinges** Rollenband 3D
- > **Inside handle** Inox ID-35
- > **Outside Handle Angular**
inox 1600mm placed on panel
- > **Glazing** 4 glasses, safety glass
inside and outside 33.1+4+4+33.1
- > **Safety cylinder** with five keys
- > **Rosette ring**
- > **3 point** security door locking
system with hooks
- > **Anodised Threshold**
- > **Ud = 0.81 W/m²K**

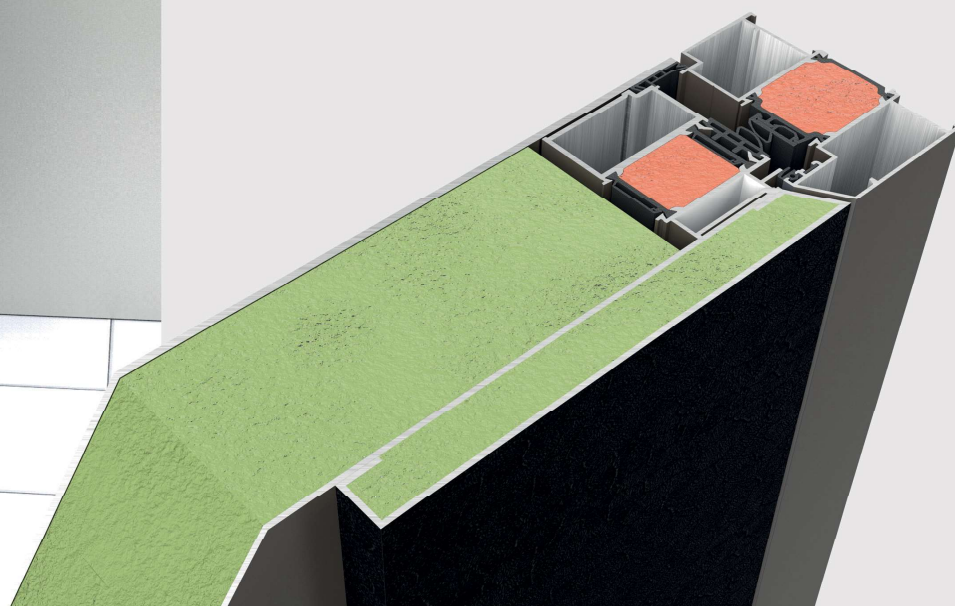



4 glasses, safety glass inside and outside 33.1+4+4+33.1



Safety cylinder EX-200



Round rosette EX-900



Rollenband EX-304



Inside Handle ID-35 EX-502



OUTSIDE HANDLE 1600MM
V440.60.1600

3 point hooklock

EX-100

SUPERIOR 3D LINE

STANDARD EQUIPMENT

VERTICAL SECTION

